

Douglas County, Nebraska Property Record - R2343550000

Information is valid as of 2010-7-15

[Print Report](#)
[View Interactive GIS Map](#)
[Treasurer's Tax Report](#)
[Subdivision Sales Search](#)

New Feature → → →

Owner

MAXWELL DELENE

2856 15 AVE CRT
 GREELEY CO 80631-0000

Property Information

Key Number:	4355 0000 23
Account Type:	Residential
Parcel Number:	2343550000
Parcel Address:	6808 N 30 ST OMAHA NE 68112-0000
Legal Description:	UPLAND TERRACE LOT 2 BLOCK 0 N 45 FT E 160 FT 45 X 160

Value Information

	<i>Land</i>	<i>Improvement</i>	<i>Total</i>
2010	\$5,100.00	\$35,600.00	\$40,700.00
2009	\$5,100.00	\$35,600.00	\$40,700.00
2008	\$5,100.00	\$35,600.00	\$40,700.00
2007	\$5,100.00	\$28,500.00	\$33,600.00
2006	\$5,100.00	\$28,500.00	\$33,600.00
2005	\$5,100.00	\$28,500.00	\$33,600.00

Land Information

<i>Acres</i>	<i>SF</i>	<i>Units</i>	<i>Depth</i>	<i>Width</i>	<i>Vacant</i>
0.16	7200.0	1.0	160.0	45.0	No

Improvement Information**Building 1**



April 2004 - Douglas County Assessor

[CLICK TO ENLARGE IMAGE](#)

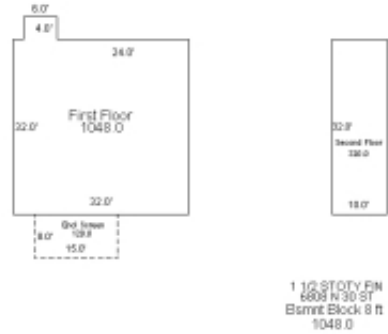

Created by ArcView 3.2a

[CLICK TO ENLARGE IMAGE](#)

Square Footage:	1368.0	Percent Complete:	100.0%
Perimeter	0.0	Quality:	Average
Unit Type:		Condition:	Poor
Built As:	1 1/2 Story Fin	Condo Square Footage:	0.0
HVAC:	Central Air to Air	Rooms:	5.0
Exterior:	Frame Stucco	Units:	1.0
Interior:	Drywall	Baths:	1.0
Roof Cover:	Composition Shingle	Bedrooms:	2.0
Roof Type:	Gable	Stories:	1.5
Floorcover:	Allowance	Foundation:	Block
		Sprinkler Square Footage:	0.0

<i>Year Built</i>	<i>Year Remodeled</i>	<i>Percent Remodeled</i>	<i>Adjusted Year Built</i>	<i>Physical Age</i>
1922	0	0%	1922	86

<i>Detail Type</i>	<i>Detail Description</i>	<i>Units</i>
Appliance	Allowance	1.0
Basement	Bsmnt Block 8 ft	1048.0
Fixture	Base Fixtures	1.0
Fixture	Bath Full	1.0
Porch	Slab Roof Ceiling	120.0

