

**PROPERTY INFORMATION**

1125

**PROPERTY DESCRIPTORS**

**PROPERTY SKETCH**

**TaxID:** 008 - A - -20-D  
**Owner:** GIN-CAR LLC  
**Co-Owner:**  
**Property Address:**  
 O  
 PAMPLIN, VA 23958

**Mailing Address:**  
 10385 RED HOUSE RD  
 RED HOUSE, VA 23963

**Legal Descr:**  
 DB 380/001 14 TRHILLBERS MANOR

**Legal Sub Div:**  
**Neighborhood:**  
**Census Tract:** CMA  
**GIS:**

**Property Descr:**

**Zoning:**

**Land Use:**

**FEMA Map:**

**Deed Liber:**

**Deed Type:** DB 380/001  
**Transfer Date:** 7/3/2007%  
**Price:** \$90,000.00

**Grantor:**  
**Deed Folio:**

**NOTES**  
 FOR RENT

**Main Bld:** DWELLING  
**Condition:** AVERAGE  
**Year Built:** 1974  
**Year Renodeled:**  
**Effective Year:** 1976  
**No. Stories:** 1  
**Quality Grade:** C  
**Frame Type:** WOOD FRAME  
**Roof Type:** GABLE  
**Roof Cover:** COMPOSITION SHINGLES  
**Ext. Finish:** BRICK  
**Foundation Type:** BRICK  
**Foundation Construct:**  
**Total No. Bed/Bath:** 2 / 1  
**Total No. Rooms:** 5

**Basement Type:** BSMT-UNFINISHED  
**Basement Sq.':** 1072  
**Basement Fin. %:** 0  
**Plumbing:** BATH-FULL,SEPTIC,WELL  
**Heat/AC:**  
**Interior:** SHEETROCK  
**Floors:** CARPET  
**Attic Sq.':**  
**Fireplace:** 1 FIREPLACE-BRICK  
**No. Chimney:** 1  
**Appraiser:**  
**Review Appraiser:**

**STRUCTURES**

Name:	Unit/Sq.':	No. Stories:	Rate:	Value:
DWELLING	1072	1	72.78	\$78,020.16
PRCH-ENCLOSED	160	N/A	20	\$3,200.00
PRCH-OPEN BRICK	88	N/A	16	\$1,408.00
WOOD DECK	256	N/A	8	\$2,048.00

sketch by gsw vva

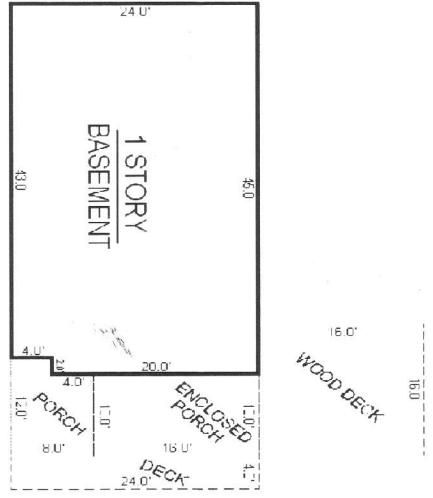

**AMENITIES**

Name:	Unit/Sq.':	Qty:	Rate:	Value:
FIREPLACE-BRICK		1	4000	\$4,000.00
BATH-FULL		1	3000	\$3,000.00
SEPTIC		1	3000	\$3,000.00
WELL		1	2000	\$2,000.00
BSMT-UNFINISHED	1072		10	\$10,720.00

**SUMMARY OF BUILDINGS**

Name	Cond	Rate	Replace	Year	PhysDep	Value
GAZEBO FV	N/A	600	\$600.00	N/A	0	\$600.00

**Structures / Amenities Total:**  
**S/A Total:** \$107,396.16  
**S/A Factor:** 1  
**S/A Replacement:** \$107,396.16  
**S/A Dep.:** 0.78  
**S/A Value:** \$83,769.00

**SUMMARY OF LAND**

**Utilities:** SEPTIC PRIVATE,WELL PRIVATE  
**Access:** PAVED  
**Road Frontage:** NO VALUE  
**Land:**  

Type	Rate	Adj	Value
HOMESITE-D(0.812)	10000	1	\$8,120.00

**SUMMARY(Current)**

**Market Value of All Improvements:** \$84,400.00  
**Market Value of All Land:** \$8,100.00  
**TOTAL MARKET VALUE:** \$92,500.00

**SUMMARY(Previous)**

**Market Value of All Improvements:** \$84,400.00  
**Market Value of All Land:** \$8,100.00  
**TOTAL MARKET VALUE:** \$92,500.00

**PROPERTY PHOTO**



**Average Total:** 0.812  
**Total Land Value:** \$8,120.00