

Wood Destroying Insect Inspection Report

Notice: Please read important consumer information on side 2.

Section I. General Information

Inspection Company, address & Phone

TERMINIX

Company's Business Lic. No.

Date of inspection

5899 Raytown Rd Suite 100
Raytown, Mo. 64133 816 3538722

Address of Property Inspected
623 Camelot
Liberty, Mo. 64068

Inspector's Name, Signature & Certification, Registration, or Lic. #

T17647

Structure(s) Inspected

Residence

Charlie Christmas
Charlie Christmas

Section II. Inspection Findings

This report is indicative of the condition of the above identified structure(s) on the date of inspection and is not to be construed as a guarantee or warranty against latent, concealed, or future infestations or defects. **Based on a careful visual inspection of the readily accessible areas of the structure(s) inspected:**

A. No visible evidence of wood destroying insects was observed.

B. Visible evidence of wood destroying insects was observed as follows:

1. Live insects (description and location): _____

2. Dead insects, insect parts, frass, shelter tubes, exit holes, or staining (description and location): _____

3. Visible damage from wood destroying insects was noted as follows (description and location): Subterranean Termite damage above back door and window next to back door inside home continuing around corner up high. Old damage, not recent

NOTE: This is not a structural damage report. If box B above is checked, it should be understood that some degree of damage, including hidden damage, may be present. If any questions arise regarding damage indicated by this report, it is recommended that the buyer or any interested parties contact a qualified structural professional to determine the extent of damage and the need for repairs.

Yes No It appears that the structure(s) or a portion thereof may have been previously treated. Visible evidence of possible previous treatment: _____

The inspecting company can give no assurances with regard to work done by other companies. The company that performed the treatment should be contacted for information on treatment and any warranty or service agreement which may be in place.

Section III. Recommendations

No treatment recommended: (Explain if Box B in Section II is checked) _____

Recommended treatment for the control of: Upon seeing visible subterranean termite damage a liquid defend system is recommended since it has been 20 yrs since last treatment

Section IV. Obstruction and Inaccessible Areas

The following areas of the structure(s) inspected were obstructed or inaccessible:

- Basement 3, 4, 5
- Crawlspace _____
- Main Level 1, 3, 4, 6
- Attic 5, 11, 21
- Garage 1, 3, 7
- Exterior 16, 17
- Porch 12
- Addition _____
- Other _____

The inspector may write out obstructions or use the following key:

- 1. Fixed ceiling
- 2. Suspended ceiling
- 3. Fixed wall covering
- 4. Floor covering
- 5. Insulation
- 6. Cabinets or shelving
- 7. Stored items
- 8. Furnishings
- 9. Appliances
- 10. No access or entry
- 11. Limited access
- 12. No access beneath
- 13. Only visual access
- 14. Cluttered condition
- 15. Standing water
- 16. Dense vegetation
- 17. Exterior siding
- 18. Window well covers
- 19. Wood pile
- 20. Snow
- 21. Unsafe condition
- 22. Rigid foam board
- 23. Synthetic stucco
- 24. Duct work, plumbing, and/or wiring

Section V. Additional Comments and Attachments (these are an integral part of the report)

Attachments TERMINIX INSPECTION GRAPH

Signature of Seller(s) or Owner(s) if refinancing. Seller acknowledges that all information regarding W.D.I. infestation, damage, Repair, and treatment history has been disclosed to the buyer.

X

Signature of Buyer. The undersigned hereby acknowledges receipt of a copy of this report (both sides) and understands the information reported.

X

Important Consumer Information Regarding the Scope and Limitations of the Inspection

Please read this entire page as it is part of this report. This report is not a guarantee or warranty as to the absence of wood destroying insects nor is it a structural integrity report. The inspector's training and experience do not qualify the inspector in damage evaluation or any other building construction technology and/or repair.

- 1. About the Inspection:** A visual inspection was conducted in the readily accessible areas of the structure(s) indicated (See front) including attics and crawlspaces which permitted entry during the inspection. The inspection included probing and/or sounding on unobstructed and accessible areas to determine the presence or absence of visual evidence of wood destroying insects. The WDI inspection firm is not responsible to repair any damage or treat any infestation at the structure(s) inspected, except as may be provided by separate contract. Also, wood destroying insect infestation and/or damage may exist in concealed or inaccessible areas. The inspection firm cannot guarantee that any wood destroying insect infestation and/or damage disclosed by this inspection represents all of the wood destroying insect infestation and/or damage which may exist as of the date of the inspection. ***For purposes of this inspection, wood destroying insects include: termites, carpenter ants, carpenter bees, and reinfesting wood boring beetles. This inspection does not include mold, mildew or noninsect wood destroying organisms.*** This report shall be considered invalid for purposes of securing a mortgage and/or settlement of property transfer if not used within ninety (90) days from the date of inspection. **This shall not be construed as a 90-day warranty.** There is no warranty, express or implied, related to this report unless disclosed as required by state regulations or a written warranty or service agreement is attached.
- 2. Treatment Recommendation Guidelines Regarding Subterranean Termites:** FHA and VA require treatment when any active infestation of subterranean termites is found. If signs of subterranean termites - but no activity - are found in a structure that shows no evidence of having been treated for subterranean termites in the past, then a treatment should be recommended. A treatment may also be recommended for a previously treated structure showing evidence of subterranean termites - but no activity - if there is no documentation of a liquid treatment by a licensed pest control company within the previous five years unless the structure is presently under warranty or covered by a service agreement with a licensed pest control company.
- 3. Obstruction and Inaccessible Areas:** No inspection was made in areas which required the breaking apart or into, dismantling, removal of any object, including but not limited to: moldings, floor coverings, wall coverings, siding, fixed ceilings, insulation, furniture, appliances, and/or personal possessions; nor were areas inspected which were obstructed or inaccessible for physical access on the date of inspection. Your inspector may write out inaccessible areas or use the key in Section IV. Crawl spaces, attics, and/or other areas may be deemed inaccessible if the opening to the area is not large enough to provide physical access for the inspector or if a ladder was required for access. Crawl spaces (or portions thereof) may also be deemed inaccessible if there is less than 24 inches of clearance from the bottom of the floor joists to the surface below. If any area which has been reported as inaccessible is made accessible, the inspection company may be contacted for another inspection. An additional fee may apply.
- 4. Consumer Maintenance Advisory Regarding Integrated Pest Management for Prevention of Wood Destroying Insects.** Any structure can be attacked by wood destroying insects. Homeowners should be aware of and try to eliminate conditions which promote insect infestation in and around their structure(s). Factors which may lead to wood destroying insect infestation include: earth to wood contact, foam insulation at foundation in contact with soil, faulty grade, improper drainage, firewood against structure(s), insufficient ventilation, moisture, wood debris in crawlspace, wood mulch or ground cover in contact with the structure, tree branches touching structure(s), landscape timbers and wood decay. Should these or other conditions exist, corrective measures should be taken in order to reduce the chances of infestation of wood destroying insects and the need for treatment.
- 5. Neither the inspecting company nor the inspector has had, presently has, or contemplates having any interest in the property inspected.**

Form NPMA-33 (9/01/04) ©2004 National Pest Management Association. All Rights Reserved. No reproduction of this form is permitted without express permission of NPMA
Form NPCA-1 is obsolete after 12/21/04

INSPECTION NOTICE
 LOCATION POSTED: _____
 DATED: _____

TREATMENT NOTICE
 LOCATION POSTED: _____
 DATED: _____

OWNER'S NAME Lindsay Crossett OCCUPANT Same
 TREATING ADDRESS 623 Camelot CITY Liberty STATE Mo ZIP 64068
 HOME PHONE 816 781 1727 BUSINESS PHONE _____ INSPECTED BY Christmas

EMAIL _____ LINEAL FOOTAGE 180' BUILT PRE 1985? YES NO YEAR BUILT: 1986
 DEPTH TO FOOTER 1-4, Front= 1-4, Right= 1-4, Rear= 4, Left= 4

TERMINIX MANAGER ACCEPTANCE BY: _____ DATE: _____

Roof Type: _____ Note "Hazard" Locations on Graph: Water Shut-off Valve (WS) Gas Meter (GM)
 Siding: _____ Sprinkler System Shut-off Valve (SSP) Exterior Natural Gas BBQ Grill/Fixture (NGF)
 Primary Use: _____

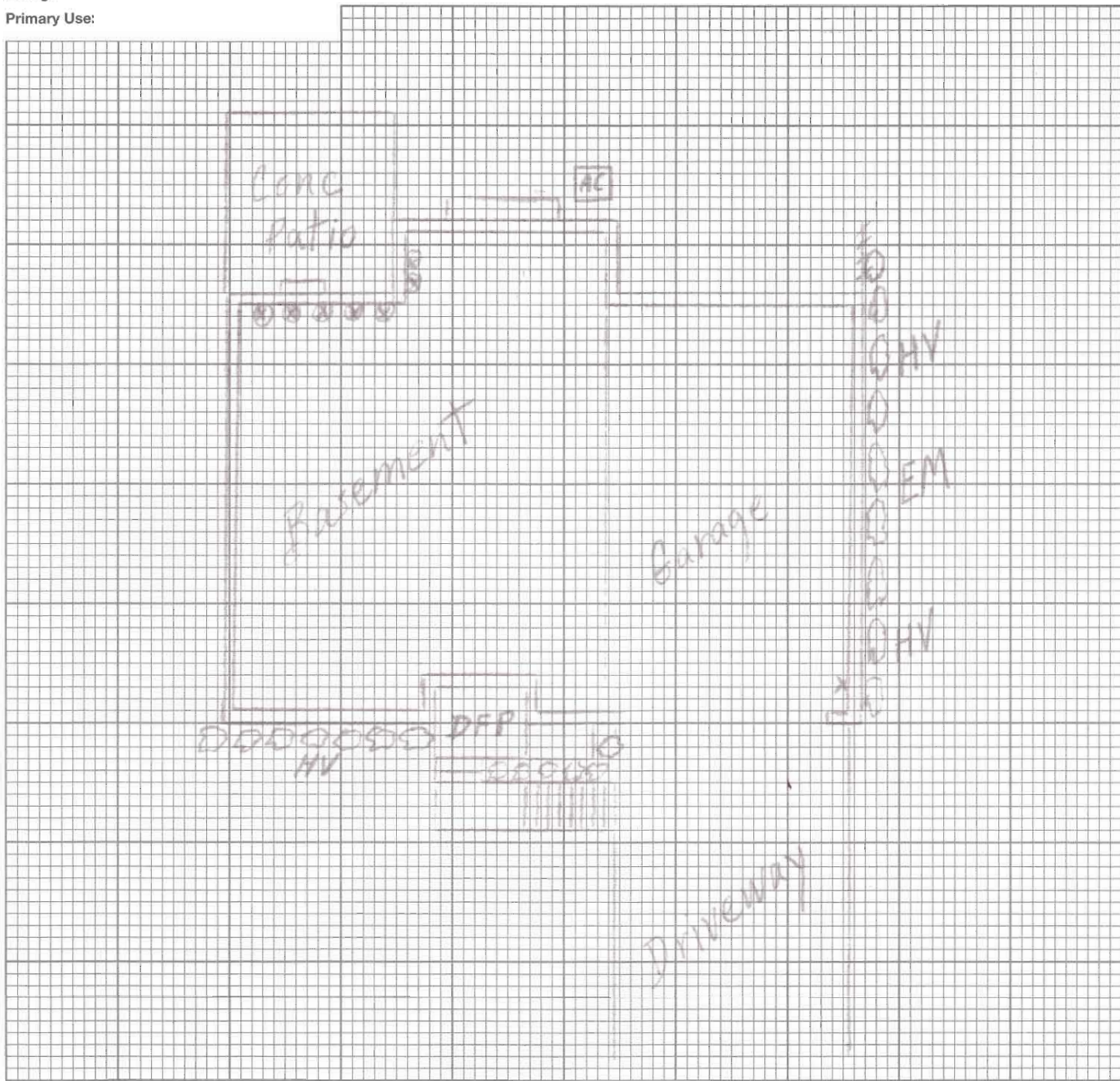

SCALE: 1:1, OTHER ___ : ___

CUSTOMER SIGNATURE ON REVISED COPY:
 Date: _____ By: _____

<input type="checkbox"/> PREVENTIVE TREATMENT OR <input checked="" type="checkbox"/> CONTROL TREATMENT	KEY TO EVIDENCE OF:	<input checked="" type="checkbox"/> SUBTERRANEAN TERMITES = X <input type="checkbox"/> DRYWOOD TERMITES = K <input type="checkbox"/> DAMPWOOD TERMITES = Z <input checked="" type="checkbox"/> EXISTING DAMAGE = ⊗ <input type="checkbox"/> FORMOSAN TERMITES = C	<input type="checkbox"/> POWDER-POST BEETLES = PPB <input type="checkbox"/> WOOD BORING BEETLES = WB <input type="checkbox"/> FUNGUS = F <input type="checkbox"/> WELL/CISTERN = W/C <input type="checkbox"/> POSSIBLE HIDDEN DAMAGE = PHD	<input type="checkbox"/> CARPENTER ANTS = CA <input type="checkbox"/> CELLULOSE DEBRIS = CD <input checked="" type="checkbox"/> EXCESSIVE MOISTURE = EM <input type="checkbox"/> FAULTY GRADE = FG <input type="checkbox"/> EARTH-WOOD CONTACTS = EC <input type="checkbox"/> INACCESSIBLE AREAS = IA
TYPE OF CONSTRUCTION: <input type="checkbox"/> CRAWL SPACE <input checked="" type="checkbox"/> BASEMENT	<input type="checkbox"/> MONOLITHIC SLAB	<input type="checkbox"/> FLOATING SLAB	<input type="checkbox"/> SUPPORTED SLAB	