

Building Sketch

Borrower/Client Premier Community Bank			
Property Address 24 Meigs Drive			
City Shalimar	County Okaloosa	State FL	Zip Code 32579
Lender Premier Community Bank			

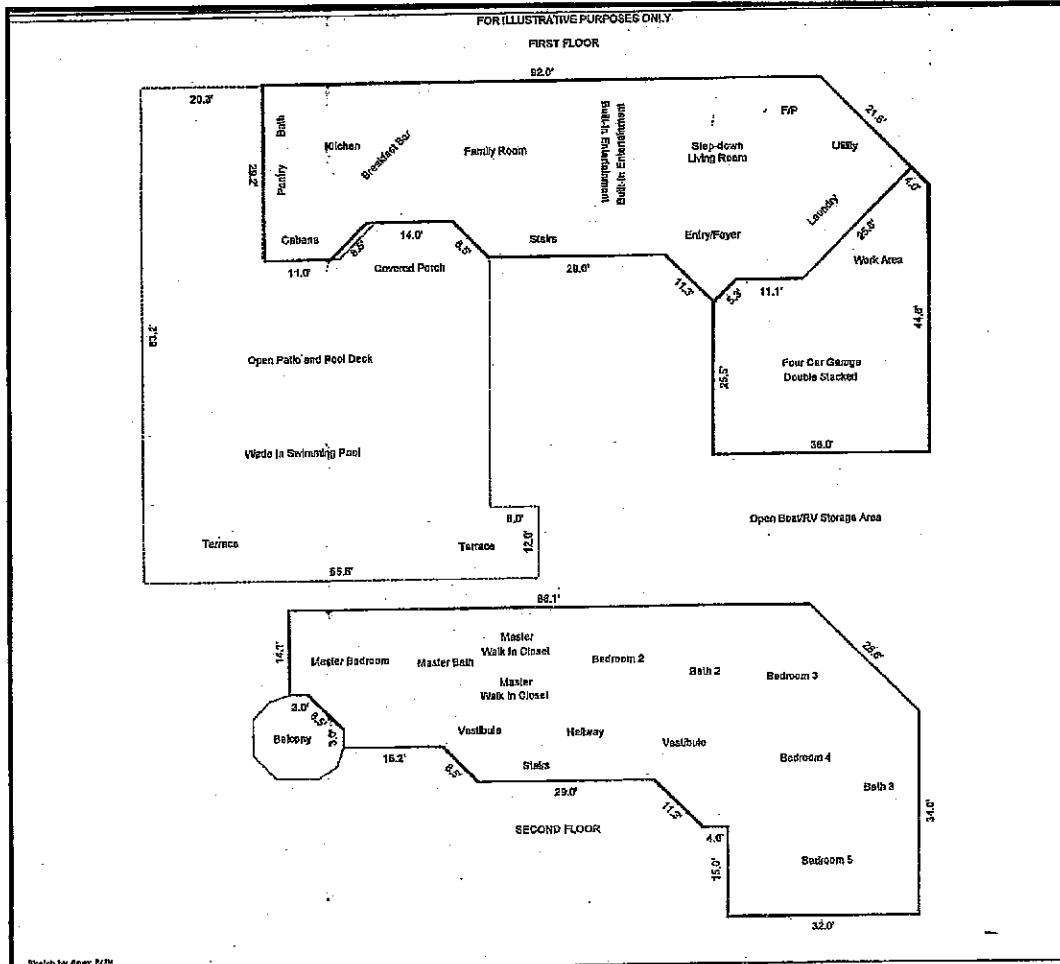

Comments:

AREA CALCULATIONS SUMMARY			
Code	Description	Size	Net Totals
GLA1	First Floor	2909.06	2909.06
GLA2	Second Floor	3436.30	3436.30
P/P	Porch	3905.02	
	Porch	Invalid	
GAR	Garage	1259.56	1259.56
TOTAL LIVABLE (rounded)			6345

LIVING AREA BREAKDOWN		
Breakdown		Subtotals
First Floor		
0.5 x	0.2' x 29.2	3.02
0.5 x	6.0 x 6.0	18.00
	23.2 x 46.8	1085.92
0.5 x	6.0 x 6.0	18.00
	6.0 x 29.0	174.00
	6.0 x 11.8	70.52
0.5 x	5.3 x 5.3	14.09
0.5 x	4.2 x 4.2	9.02
	4.2 x 7.5	31.08
	20.0 x 23.2	464.54
	11.1 x 33.5	371.35
	11.0 x 29.2	321.50
0.5 x	21.6 x 21.6	232.93
0.5 x	3.0 x 3.0	4.35
	3.0 x 30.5	90.05
18 unlisted calculations		3436.30
33 Calculations Total (rounded)		6345