



# Lawrence County GIS Internet Report



## Assessment Information

**Parcel Number:** 11 06 23 0 000 015.000    **Year Last Appraised:** 0  
**Account Number:** 77410    **Total Appraised Value:** \$17,000

General Information	
<b>Owner:</b>	PROPERTY INVESTING ENTERPRISES
<b>Owner:</b>	
<b>Property Address:</b>	
<b>Mailing Address:</b>	POB 1209 DECATUR, AL 35602

Tax Information	
<b>Tax District:</b>	1
<b>Total Taxes:</b>	\$75.66
<b>Amount Paid:</b>	\$0

( Tax amount for year 2007. Subject to change for 2008 tax year. )

Other Information			
<b>Deeded Acre:</b>	81	<b>Deed Book:</b>	104
<b>Total Acre:</b>	81	<b>Deed Page:</b>	225
<b>Timber Acre:</b>	0	<b>Deed Date:</b>	
<b>Deeded Lot Frontage:</b>	0	<b>Section:</b>	23
<b>Lot Frontage:</b>		<b>Township:</b>	05S
<b>Land Type:</b>	N/A	<b>Range:</b>	08W
<b>Subdivision:</b>	N/A	<b>Neighborhood:</b>	11



Tommy Praytor  
Revenue Commissioner

# Lawrence County GIS Internet Report

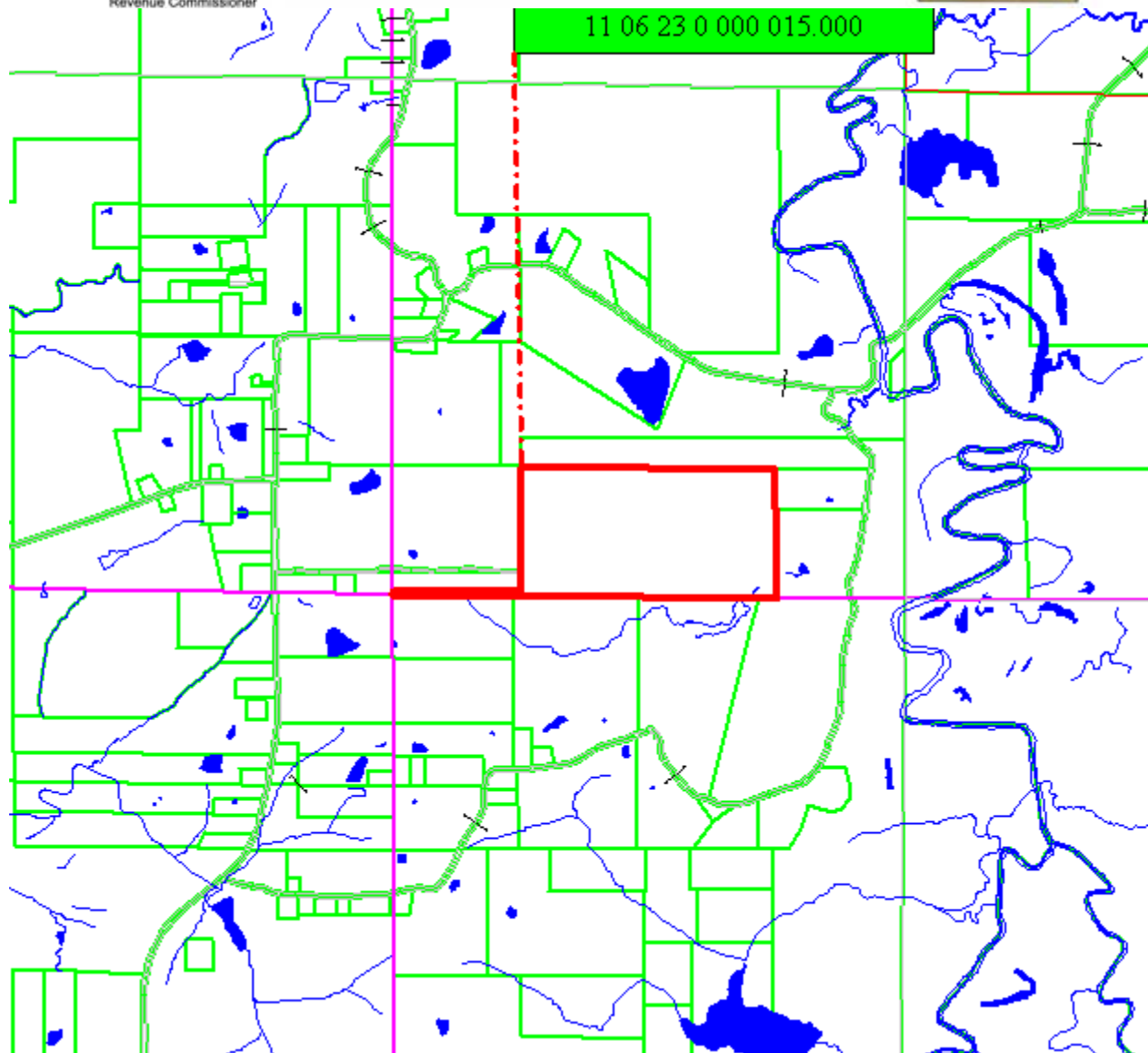

**Lawrence County, Alabama Disclaimer**  
Information deemed reliable but not guaranteed.  
Copyright © 2008