

Soils Map

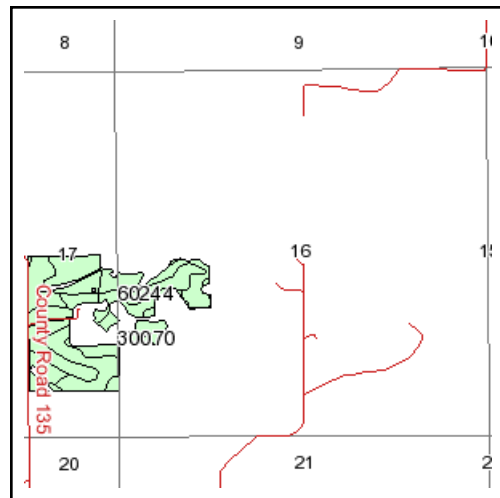

State: **Missouri**
 County: **Marion**
 Location: **017-059N-007W**
 Township: **Round Grove**
 Acres: **66.2**

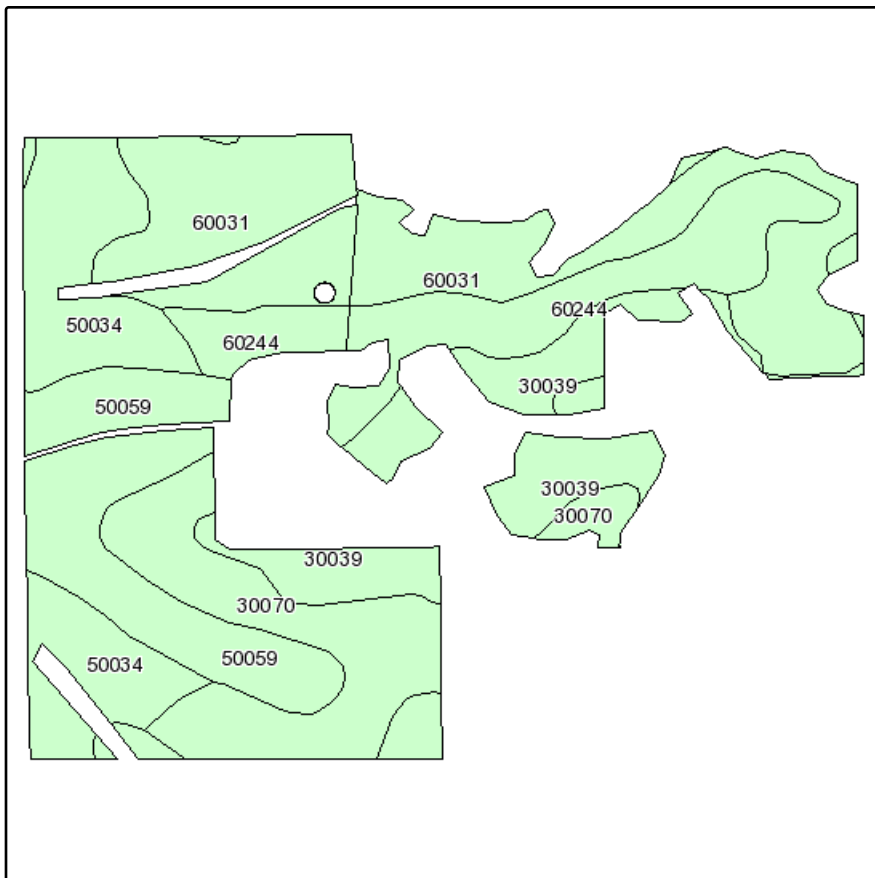

Maps provided by:



Fsa borders provided by the Farm Service Agency as of May 23, 2008.
Soils data provided by USDA and NRCS.

Code	Soil Description	Acres	Percent of field	Non-Irr Class
60031	Winfield silt loam, 9 to 14 percent slopes, eroded	17.1	25.7%	IVe
30070	Gorin silt loam, 5 to 9 percent slopes	10.1	15.3%	IIIe
50059	Mexico silt loam, 1 to 4 percent slopes, eroded	10	15.1%	IIe
50034	Leonard silt loam, 5 to 9 percent slopes	9.9	15.0%	IIIe
30039	Armstrong loam, 9 to 14 percent slopes, eroded	9.4	14.2%	IVe
60244	Winfield silt loam, 5 to 9 percent slopes, eroded	9	13.6%	IIIe
50040	Lindley loam, 14 to 20 percent slopes	0.7	1.1%	VIe
Weighted Average				